

# CSM-5634A

## Color TFT LCD Monitor

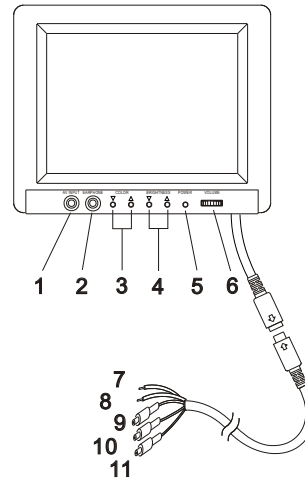

### APPEARANCE



1. AV INPUT
2. EARPHONE JACK
3. COLOR
4. BRIGHTNESS
5. POWER SWITCHER
6. VOLUME
7. RED WIRE  
DC 12V Input
8. BLACK WIRE  
Connect to ground
9. RED RCA JACK  
Right Audio Input
10. WHITE RCA JACK  
Left Audio Input
11. YELLOW RCA JACK  
Video Input

## INSTRUCTION MANUAL

— 1 —

### SPECIFICATIONS

DISPLAY	5.6" COLOR TFT LCD
RESOLUTION	960(W) x 234(H)
ACTIVE AREA	113.3(W) x 84.7(H)
BACK LIGHT	CCFT
INPUT SIGNAL	NTSC & PAL System
INPUT SIGNAL	Autoswitch
	1 Vp-p / 75 ohm
LAMP LIFE	10,000 hr.
SPECIFICATION OF AUDIO	
INPUT IMPEDANCE	10 K
OUTPUT OF AUDIO	0.3W max.
EARPHONE	16 / 32
BAND WIDTH	15 KHz
INPUT LEVEL	1 Vp-p
POWER SOURCE	DC 12V ±15% (ripple 0.5 Vp-p max.)
POWER CONSUMPTION	8W max.
BRIGHTNESS	300cd/m <sup>2</sup> TYP.
VIEWING ANGLE	TOP 30 deg. BOTTOM 10 deg. LEFT/RIGHT 45 deg.
OPERATING TEMPERATURE	0°C ~ 60°C
STORAGE TEMPERATURE	-20°C ~ 60°C
OPERATING HUMIDITY	85% RH max.
STORAGE HUMIDITY	85% RH max.
OVERALL DIMENSIONS	156(W) x 126(H) x 34.5(D)
WEIGHT	406 g

### ATTACHMENTS

- BRACKET :  
"P/N : ST-011"



- 4 POLES CABLE FOR AV INPUT : "P/N : 55-1500-A001"  
Length : 150 cm

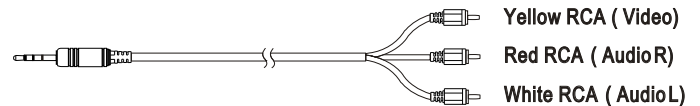

### CAUTION

1. Don't expose to direct sunlight. ( refer to specification)
2. Don't expose temperature extremes. (refer to specification)
3. Avoid dropping and strong impact.
4. Avoid wet and dust.
5. Never attempt to take apart and maintain by yourself.